

- TOP PERFORMANCE
- TOP QUALITY
- TRIED AND TRUSTED IN THE FIELD

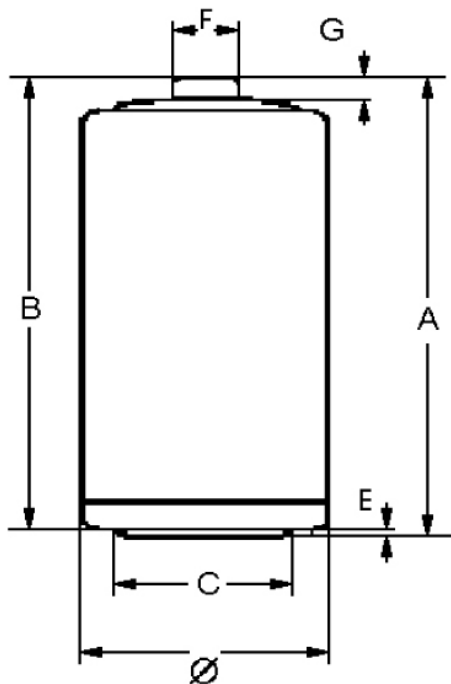

Type Designation	4020	
Designation IEC	LR20	
System	Zn-MnO ₂ (Alkaline)	
Shelf Life (Coding)*	5 years	
Nominal Voltage [V]	1.5	
Typical Capacity C [mAh]	17000 (discharge with high-resistance)	
Permissible Temperature Range	- 20 °C ... 50 °C	
Weight, approx. [g]	138	
Volume [ccm]	51.3	
Dimensions [mm]	min:	max:
	Ø	32.3 34.2
	A	- 61.5
	B	59.5 -
	C	18.0 -
	E	- 1.0
	F	- 9.5
	G	1.5 -

Typical Capacities (at 20°C)

Discharge Type	Load	End Voltage[V]	0.9
4M/15M,8H/D,7D/W Portable lighting (2)	1.5 Ω	Time [h]	14,9
		Capacity [Ah]	11,2
		Energy [Wh]	12,6
4M/H,8H/D,7D/W Portable lighting (1)	2.2 Ω	Time [h]	25,9
		Capacity [Ah]	13,4
		Energy [Wh]	15,3
1H/D,7D/W Toy	2.2 mA	Time [h]	29,4
		Capacity [Ah]	14,3
		Energy [Wh]	15,8
2H/D,7D/W Portable Stereo	600 mA	Time [h]	16,4
		Capacity [Ah]	10,1
		Energy [Wh]	11,2
4H/D,7D/W Radio	10 Ω	Time [h]	134,4
		Capacity [Ah]	16,2
		Energy [Wh]	19,1

No publication or circulation of data to third parties without consent of VARTA Consumer Batteries

* In consideration of typical loss of capacity at storage and application.